

**CALOTTE**  
Caps

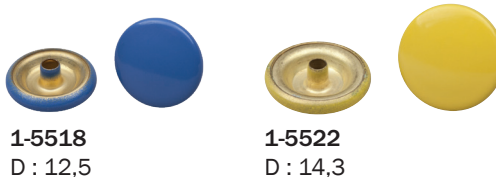

**BOITIER**  
Socket

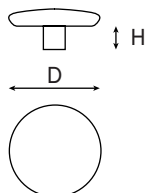
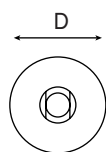

**BOULE**  
Stud

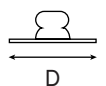

**OUILLET DE BOULE**  
Post

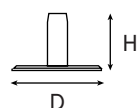

\*Dimensions en mm - Tolérance ± 0,3mm

## Bouton Pression / STYLE 80

Snap Fasteners  
Laiton - Brass



### CALOTTE Caps

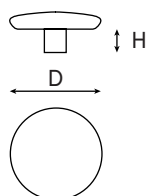

LAITON



PLASTIQUE



### BOITIER Socket

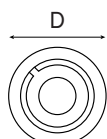

### BOULE Stud

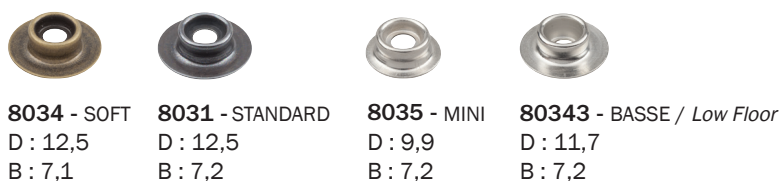
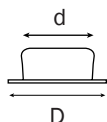

### OEILLET DE BOULE Post

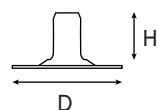

### RONDELLE



\*Dimensions en mm - Tolérance ± 0,3mm

**CALOTTE**

Caps

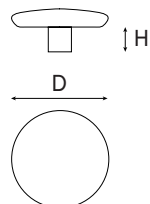

LAITON

PLASTIQUE



**1-95724**

D : 15

H : 3,7

**1-9524**

D : 15

H : 4,1

**1-95124**

D : 15

H : 7,3

**92-9524**

D : 15

H : 5

**92-95124**

D : 15

H : 6,8

**D99-9524 D532**

D : 15

H : on request

**BOITIER**

Socket

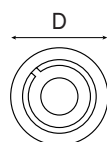

**9521 - STANDARD**

D : 14

**9524 - HARD**

D : 14

**BOULE**

Stud

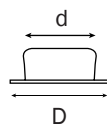

**9532 - BASSE / Low Floor**

D : 14

d : 10

**9531**

D : 14

d : 10

**9534 - SOFT**

D : 14

d : 9,9

**95319 - HARD**

D : 14

d : 10,3

**OEILLET DE BOULE**

Post

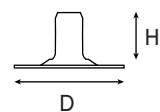

**9545**

D : 14

H : 5,8

**95405**

D : 14

H : 6,6

**9541**

D : 14

H : 7,1

**9542**

D : 14

H : 9,1

**9546**

D : 13,7

H : 6,1

**1-95124**

D : 15

H : 7,3

**Les Calottes 95 Métal et Plastique existent en Ø 12,7 mm sur demande.**

*Caps 95 Metal and Plastic exist in Ø 12,7 mm on request.*

**Les Boîtiers 95 s'adaptent aux Calottes 80 sur demande.**

*Sockets 95 are adapted with Caps 80 on request.*

\*Dimensions en mm - Tolérance ± 0,3mm